

GROUND FLOOR
APPROX. FLOOR
AREA 108.8 SQ.M.
(1171 SQ.FT.)

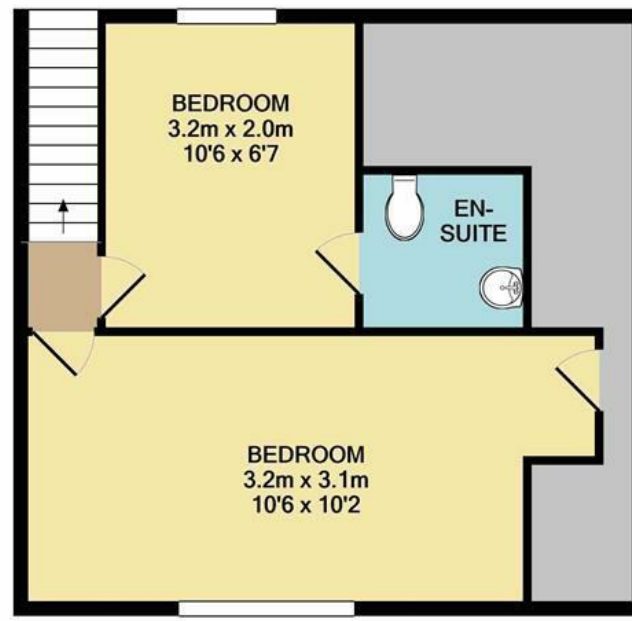

1ST FLOOR
APPROX. FLOOR
AREA 47.7 SQ.M.
(514 SQ.FT.)

TOTAL APPROX. FLOOR AREA 156.5 SQ.M. (1685 SQ.FT.)

Whilst every attempt has been made to ensure the accuracy of the floor plan contained here, measurements of doors, windows, rooms and any other items are approximate and no responsibility is taken for any error, omission, or mis-statement. This plan is for illustrative purposes only and should be used as such by any prospective purchaser. The services, systems and appliances shown have not been tested and no guarantee as to their operability or efficiency can be given
Made with Metropix ©2021

Energy Efficiency Rating		Current	Potential
Very energy efficient - lower running costs			
(92 plus)	A		
(81-91)	B		
(69-80)	C		
(55-68)	D		
(39-54)	E		
(21-38)	F		
(1-20)	G		
Not energy efficient - higher running costs			
England & Wales		EU Directive 2002/91/EC	
			79
			62

Disclaimer – In accordance with the Property Misdescriptions Act, the company gives notice that all descriptions, references to condition, necessary permissions for use and other details are given in good faith and believed to be correct, but any intending lessees do not rely on them as statements of fact, but must satisfy themselves by inspection or other means, as to their accuracy.



Varvel Close | Norwich | NR7
Guide Price £280,000 - £290,000



abbotFox presents this deceptively spacious semi-detached chalet. Located within a quiet close in the sought after residential location of Sprowston, this is an ideal opportunity for any young family. With schools, parks and a variety of local amenities within easy reach, this home offers a flexible layout to offer two double bedrooms, one of which has an en suite WC to the first floor, with an inviting entrance hall, spacious lounge, kitchen, dining area, conservatory, boot room, two further bedrooms and a family bathroom to the ground floor. Occupying a spacious plot, with ample off road parking, private enclosed rear gardens and a detached garage, this home has been well maintained by the current owners. An internal viewing comes highly recommended.

Guide price £280,000 - £290,000

